

BEECH CROFT ROAD PROPOSED DIY STREET PLAN DRAFT 10.3 23 MAY 2009

Beech Croft Road, Summertown, Oxford OX2

Refer to specification sheet for details of these DIY features



ITEMS 4, 3, 5, 11, 16, 18: Bond pattern pattern



ITEMS 2, 15
Large Tree Planter



ITEMS 4, 9, 10, 13
Small Tree Planter



ITEM 7:
Standard wood picnic table



ITEM 8:
Trellis-back planters



ITEM 6:
Bespoke salvaged iron railing cycle rack bolted onto street



ITEMS 12, 14:
Triple-hoop or 'Sheffield' cycle rack bolted onto street

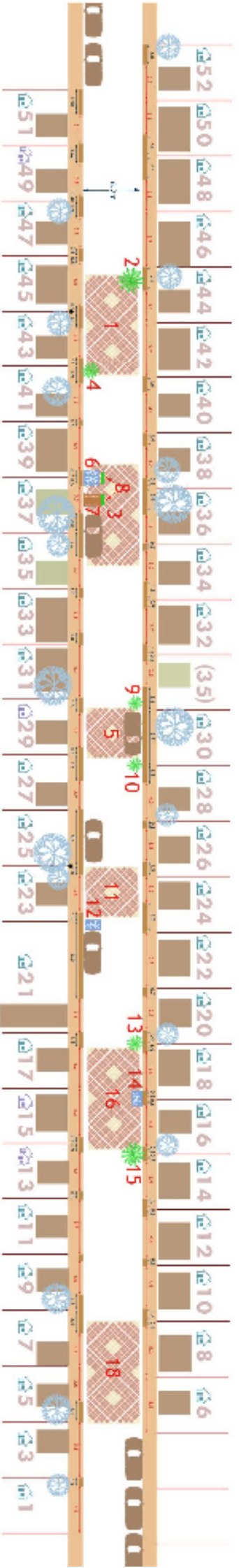

KEY: FEATURES

- EXISTING TREE
- PROPOSED SITE OF PLANTED TREE
- PROPOSED SITE OF PLANTED SLATS
- PROPOSED SITE OF PICNIC TABLE
- PROPOSED SITE OF PLANTED TREE
- EXISTING ON-STREET CAR WASHING
- PROPOSED SITE OF ON-STREET BICYCLE MARKING
- EXISTING ON-STREET CAR WASHING
- PROPOSED SITE OF ON-STREET BICYCLE MARKING
- STREET-PAVING
- OCCAS ONN-USE OFF-STREET MARKING
- CONSTANT-USE OFF-STREET MARKING

BEECH CROFT RESIDENTS' ASSOCIATION (BCRA)
 SUSITRANS DIY STREETS PILOT SCHEME
 In consultation with the BCRA and the
 residents of Beech Croft Road

Prepared by: Ied Dewan, JK RA designer
 37 Beech Croft Road, Oxford OX2 7AF
 01865-553-517 headw@chroftroadw@ch.org.uk